

*Conical Horn Antenna
12-18 GHz Frequency Range, 20 dBi Typ. Gain*

Conical Horn Antenna Data Sheet

RM-CHA62-20

Features

- Low VSWR
- Small Size
- Broadband Operation
- Light weight

Descriptions

RF MISO's **Model RM-CHA62-20** is a conical horn antenna that operates from 12 to 18GHz, The antenna offers 20 dBi typical gain. The antenna VSWR is 1.1:1 typical. It can be widely used in EMI detection, orientation, reconnaissance, antenna gain and pattern measurement and other application fields.

Specifications

RM-CHA62-20		
Parameters	Typical	Units
Frequency Range	12-18	GHz
Gain	20 Typ.	dBi
VSWR	1.1 Typ.	
Polarization	Linear	
3db Beamwidth	E-Plane:13 Typ. H-Plane:16 Typ.	Deg.
Cross Polarization	45 Typ.	dB
Connector	SMA-Female	
Waveguide	WR62	
Finishing	Paint	
Size (L*W*H)	262*Ø92.5(±5)	mm
Weight	0.288	kg
Power Handling,Peak	50	w
Power Handling,CW	3000	w

Conical Horn Antenna
12-18 GHz Frequency Range, 20 dBi Typ. Gain

Conical Horn Antenna Data Sheet

RM-CHA62-20

Outline Drawing

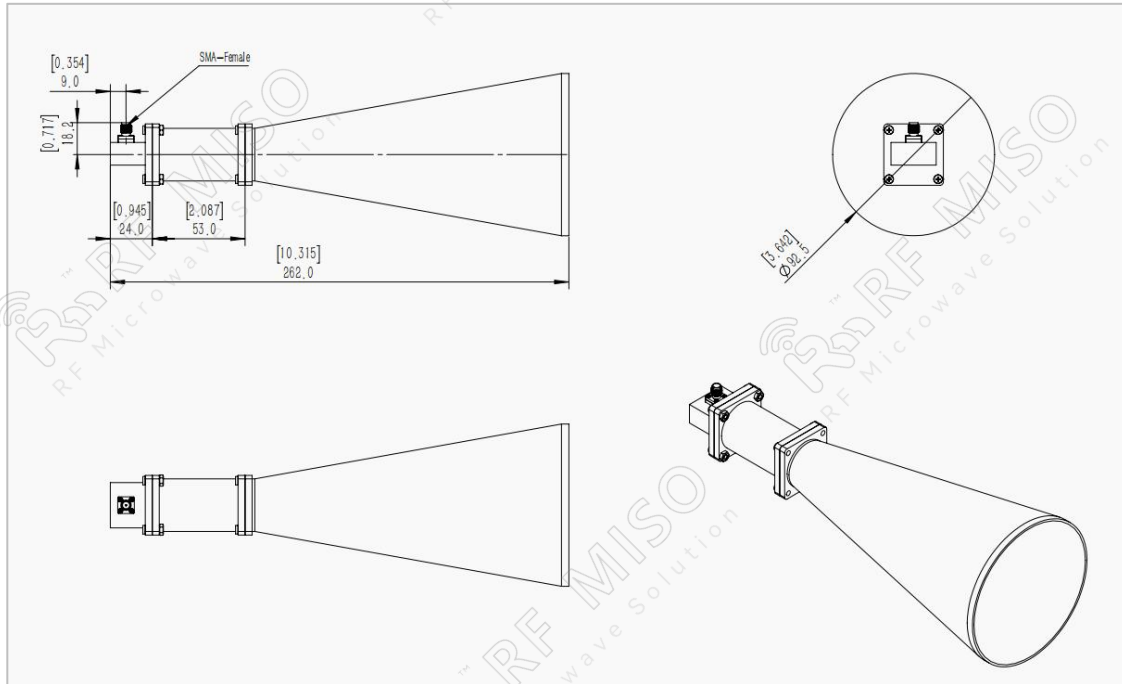

Simulated Results

Gain

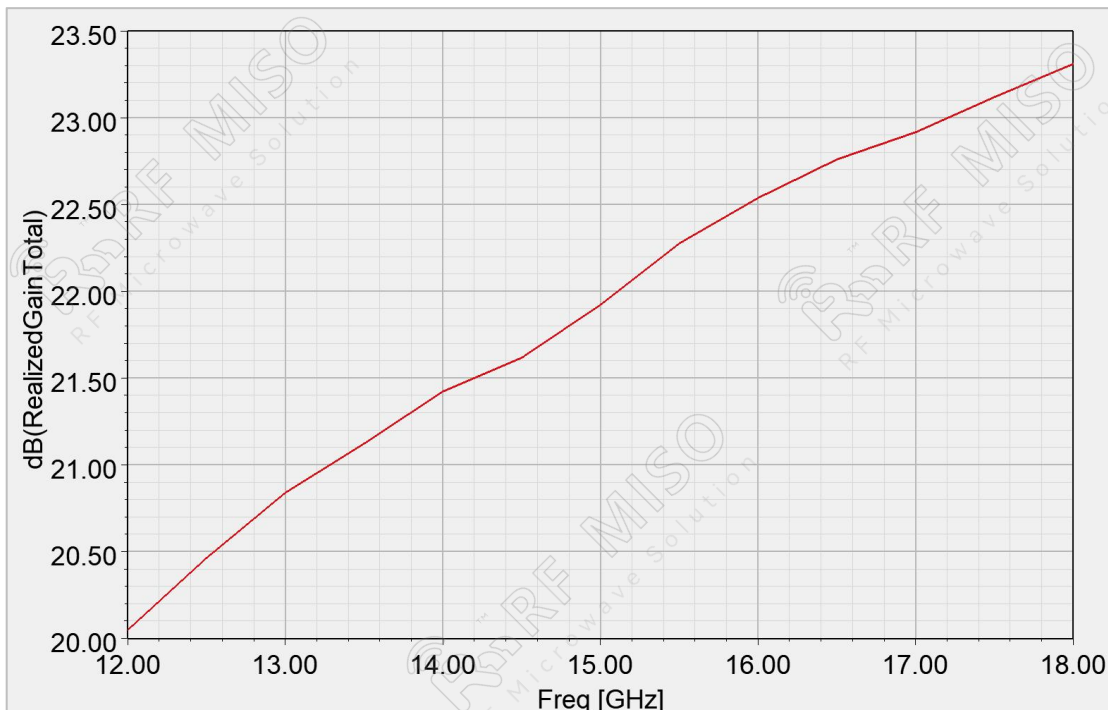

Conical Horn Antenna
12-18 GHz Frequency Range, 20 dBi Typ. Gain

Conical Horn Antenna Data Sheet

RM-CHA62-20

VSWR

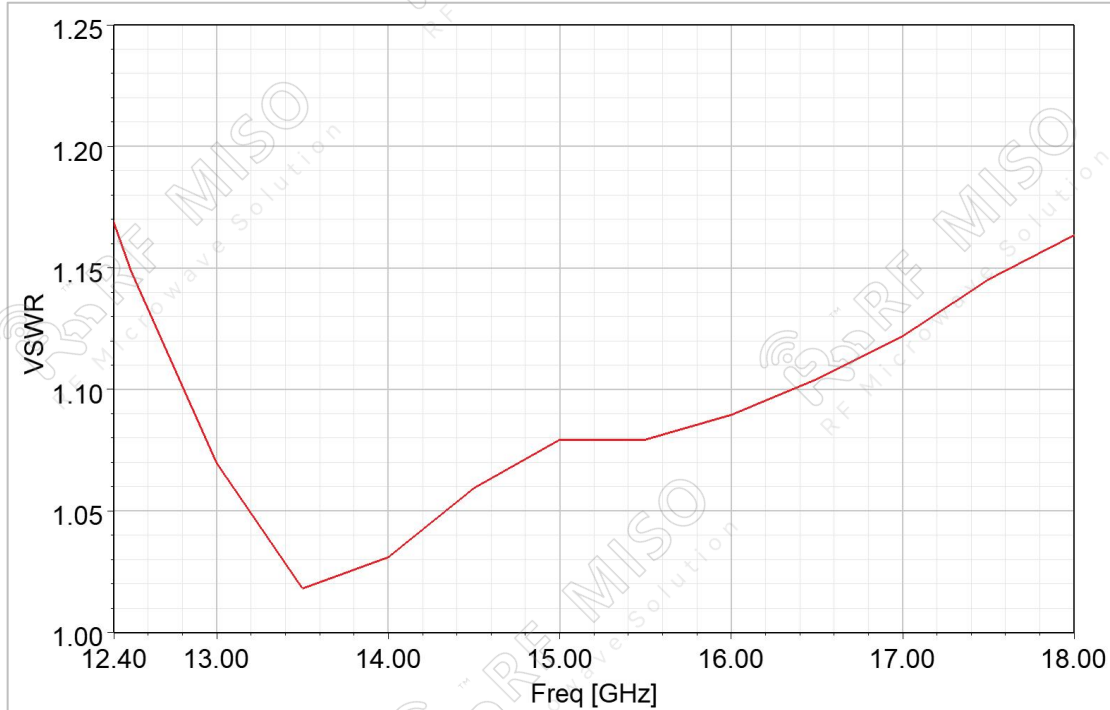

XPD

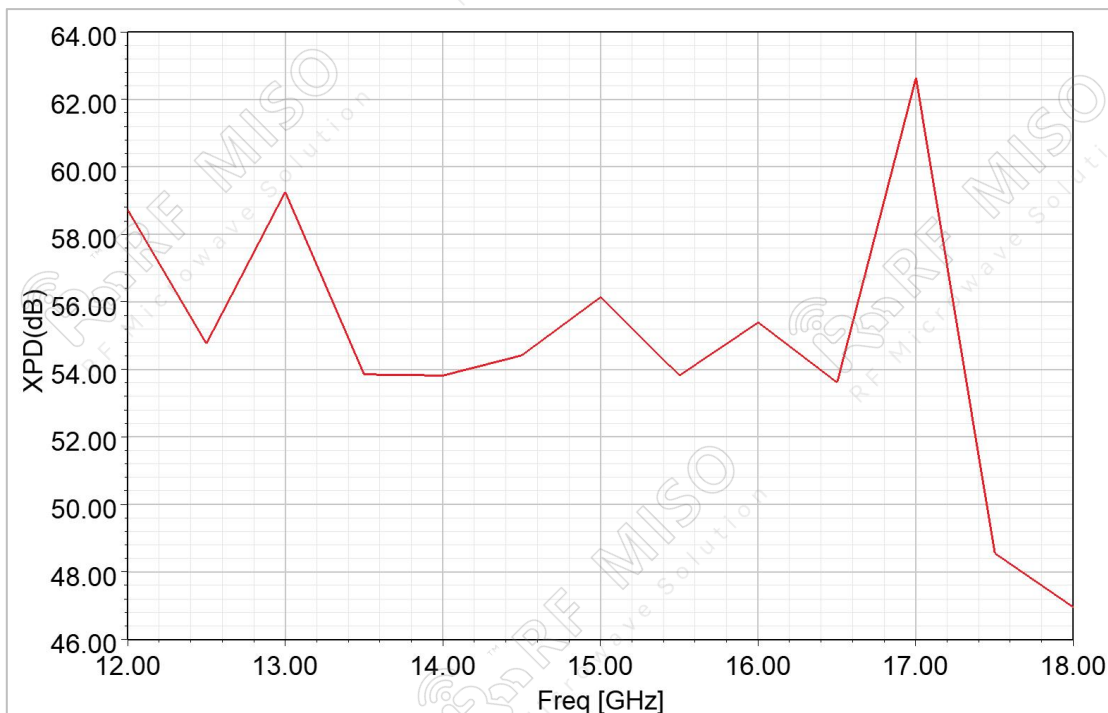

Conical Horn Antenna
12-18 GHz Frequency Range, 20 dBi Typ. Gain

Conical Horn Antenna Data Sheet

RM-CHA62-20

Pattern_E Plane

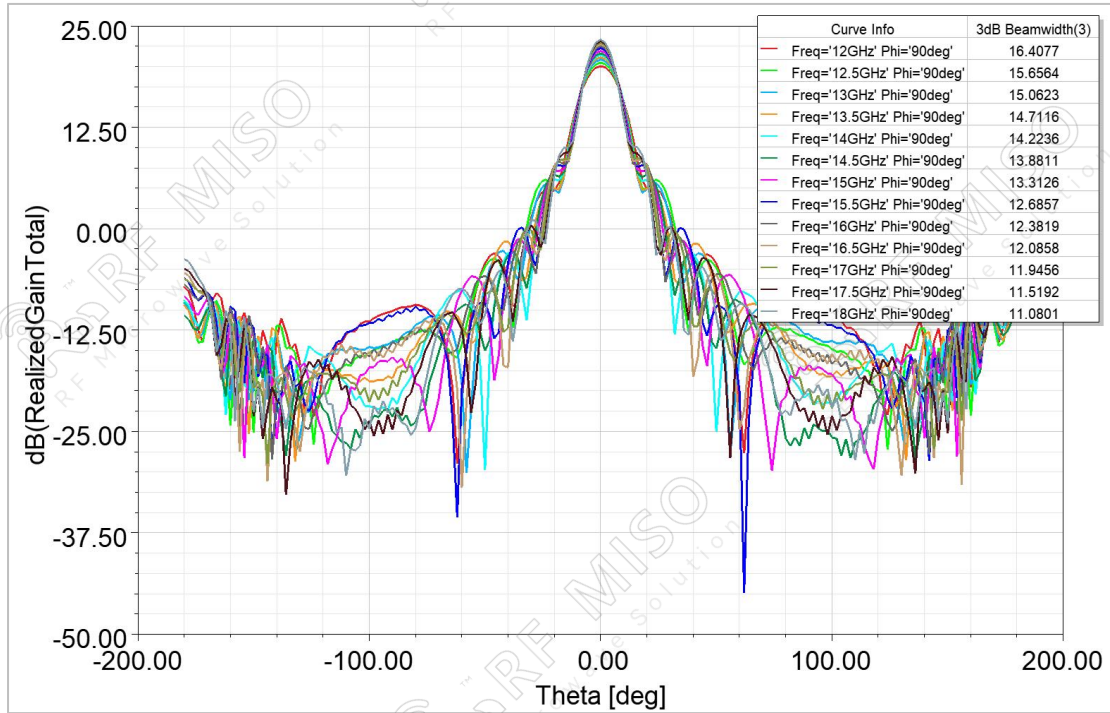

Pattern_H Plane

